

## Channel Accessories

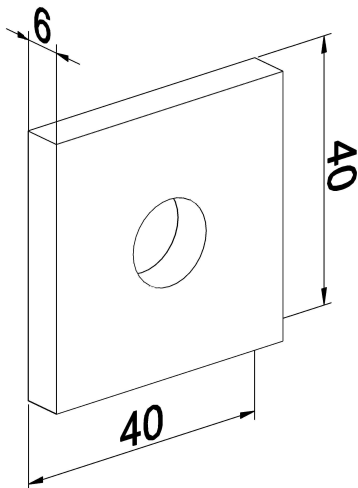

## Properties

**Standards**  
EN 10025

**Material**  
Steel

**Finish**  
Electro Zinc Plated GI /  
Hot dip galvanized HDG /  
Stainless Steel A4

## Technical Data

Item	Art number, GI	Art number, HDG	Hole Size (mm)
CSW M08	4108	4208	8
CSW M10	4110	4210	10
CSW M12	4112	4212	12